

South Carolina

Pursuant to a warrant from John Bremer Esq. Deputy Surveyor gen. dated the 2. day of March 1773 I have admeasured and laid out unto James Hawkins a tract of land containing four hundred acres situate in Caaven County the North side of Tigger River on Cain Creek bounded S. E. by Jonathan Hawkins land and Isaac Cook and N. E. by J. Hawkins S. by Joseph Hallsworth N. W. by Benj. Hawkins and vacant land all other sides E. by J. Hallsworth and hath such shape and marks as the annexed Plat Represents.

Surveyed the 18th March 1773

Recorded the 23rd Sept. 1784

John Armstrong Esq.

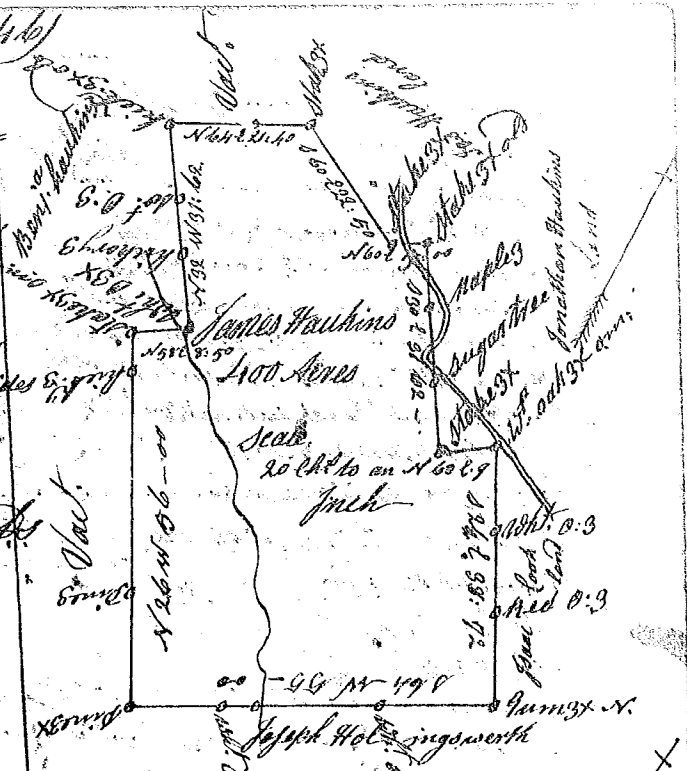

South Carolina

Pursuant to a precept from John Bremer Esq. Deputy Surveyor General Dated the second day of March 1773, I have Admeasured & laid out unto Jonathan Hawkins a Tract of land containing one hundred acres, Situate in Caaven County the North side of Tigger River on Cain Creek bounded N. W. by land of James Hawkins's & N. E. by Isaac Cook's land all other sides by Vac. Land and hath such shape and marks as the Annexed plat Represents. Done this 18th day of March 1773 J. Armstrong Esq. Surveyor

Recorded the 23rd Sept. 1784

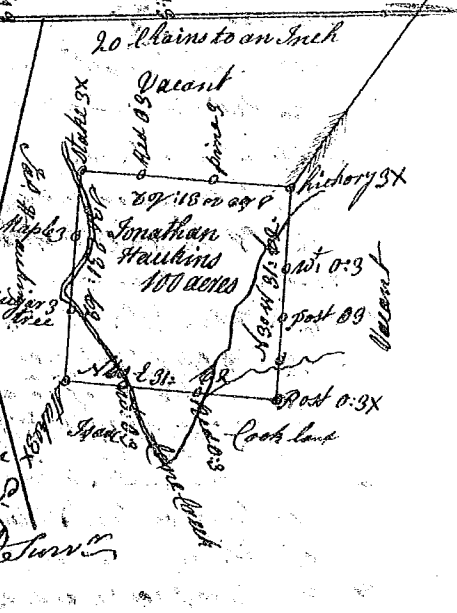

State of South Carolina

Single Six District on the East side of the ancient Boundary line Pursuant to a warrant from John Norman Esq. Commissioner of Location Baring date the 5 July 1784 I have Admeasured and laid out unto Philimon Barry Waters a tract of land containing four hundred & seventy two acres, lying on the South side of Enore River bounded to the N. W. by John Spawors land S. W. by Wallworth S. E. by William Hall's land & Joseph Patterson's N. E. by James Browns land to the N. by Geo. Rogers and Wallworth and hath such shape and marks as the above plat Represents.

Recorded the 23rd Sept. 1784

Philimon Barry Waters 472 acres - Scale 20 Chains to an Inch

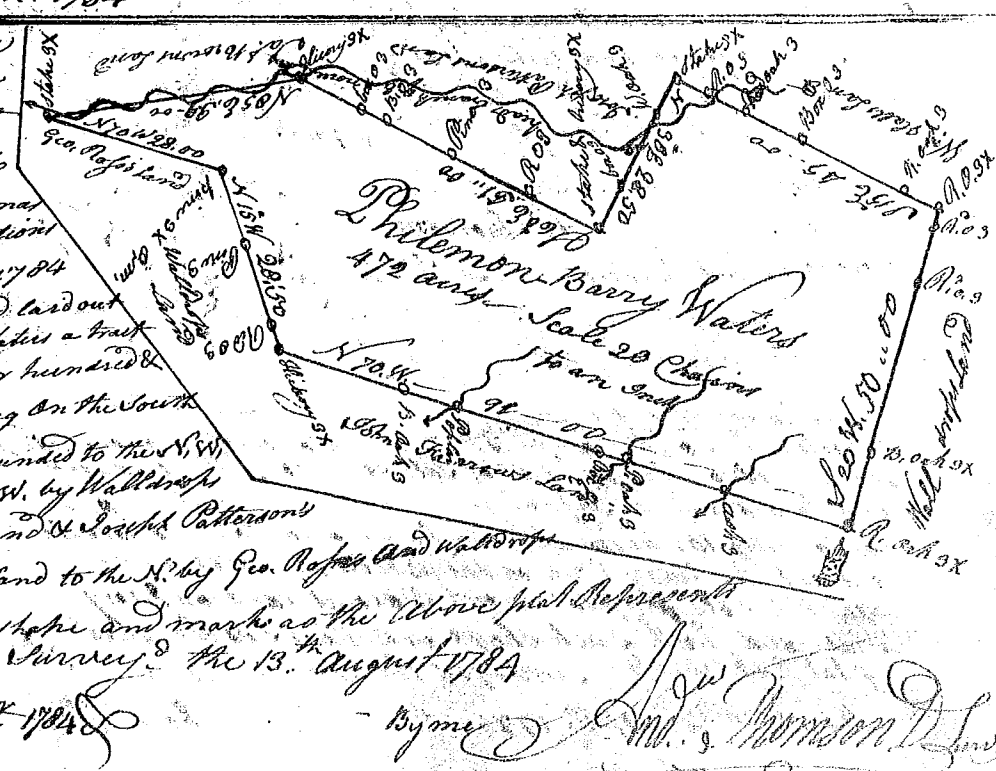

John Norman Esq. Surveyor